

**This electronic collection of documents is provided
for the convenience of the user
and is Not a Certified Document –**

**The documents contained herein were originally issued
and sealed by the individuals whose names and license
numbers appear on each page, on the dates appearing
with their signature on that page.**

**This file or an individual page
shall not be considered a certified document.**

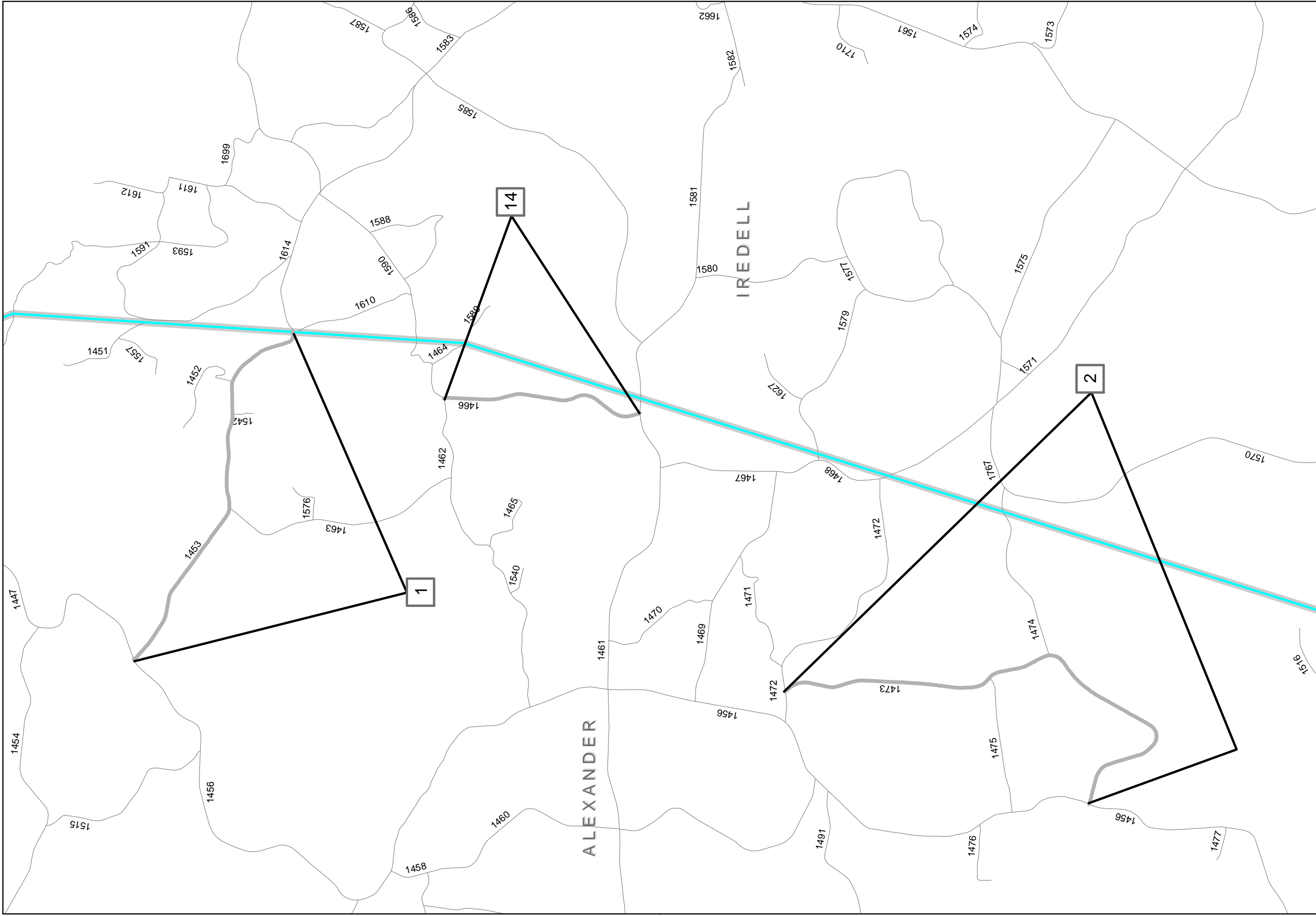

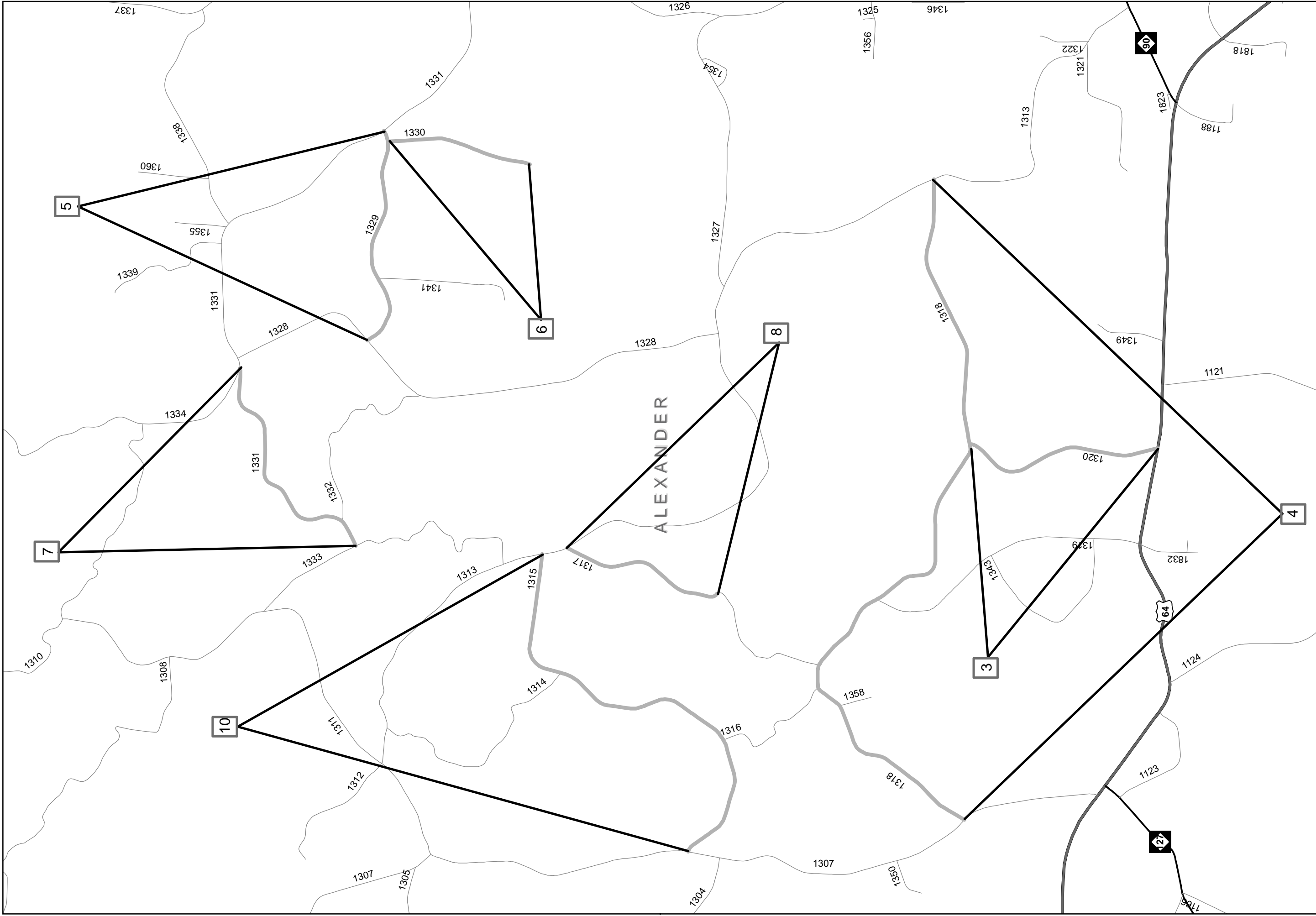

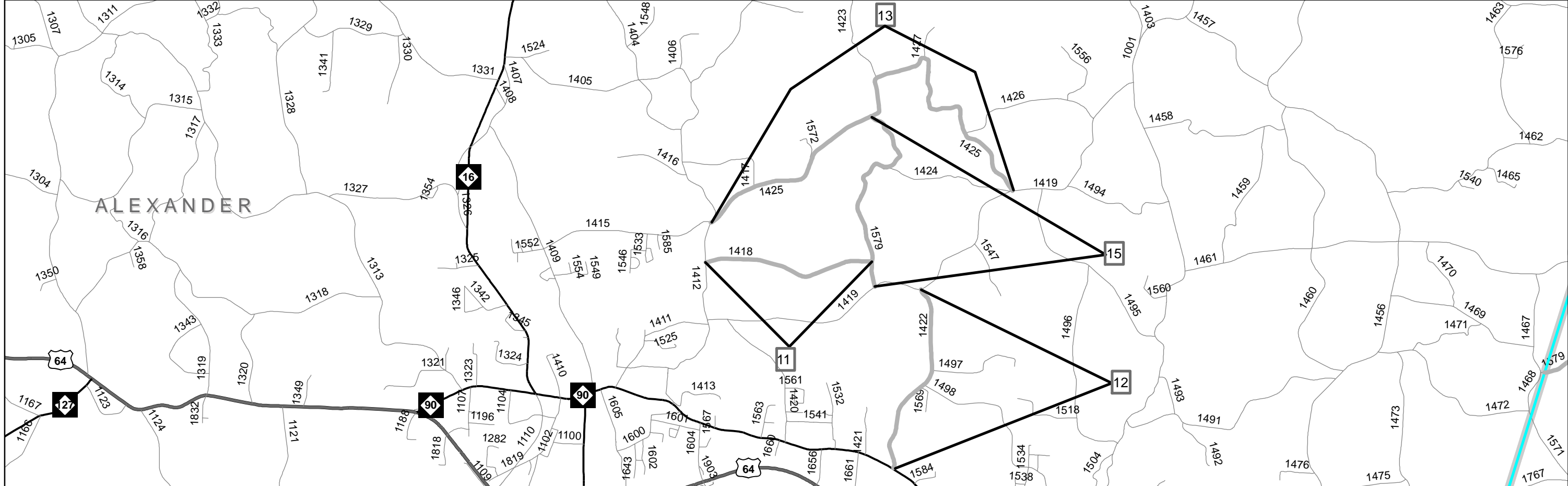
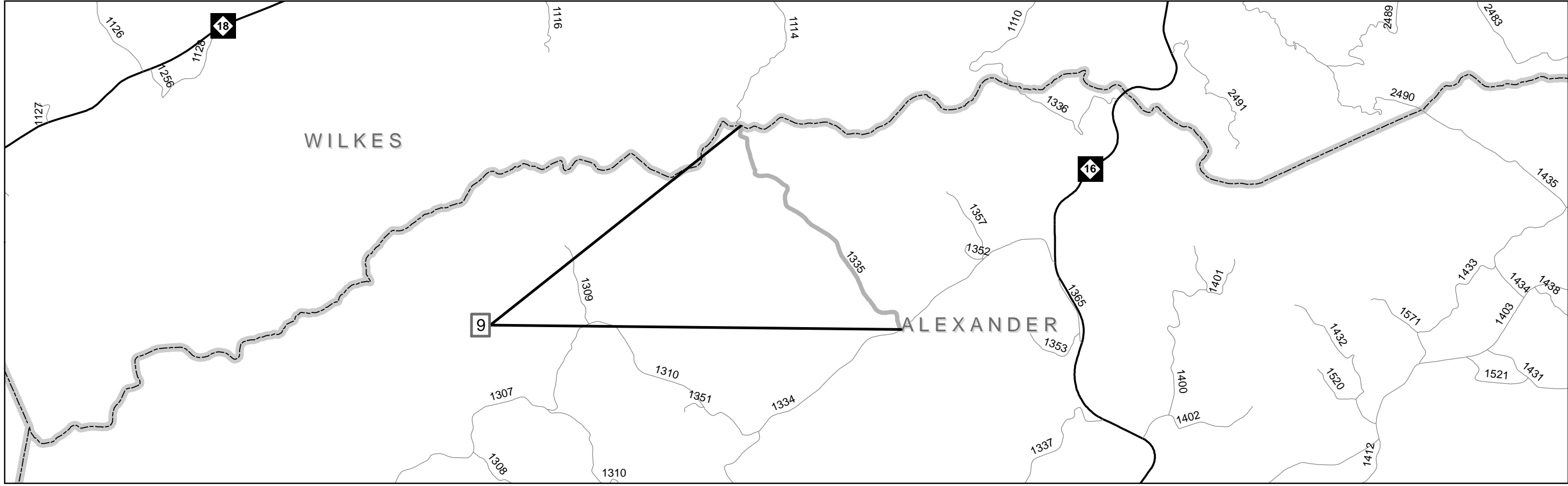

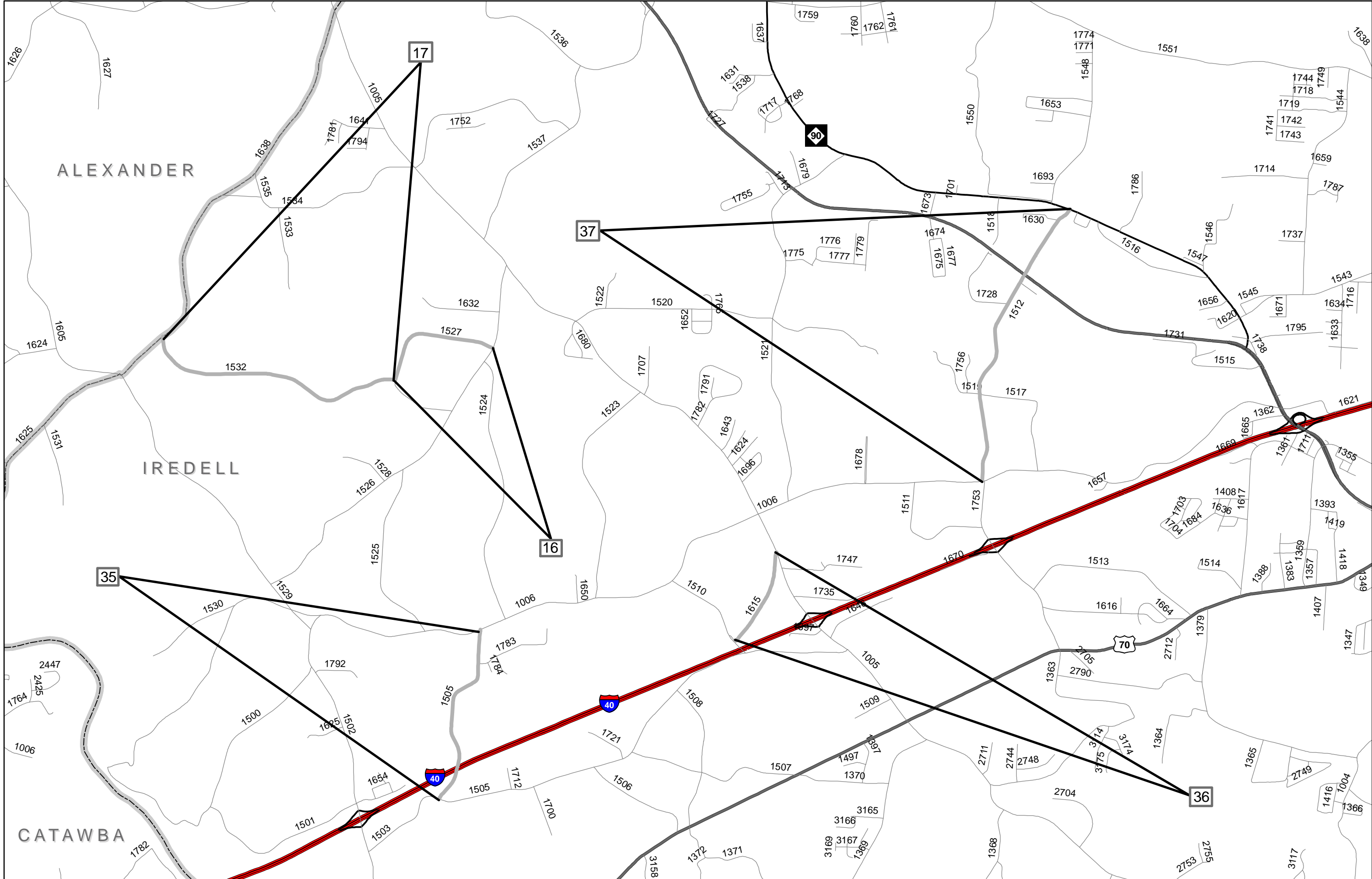

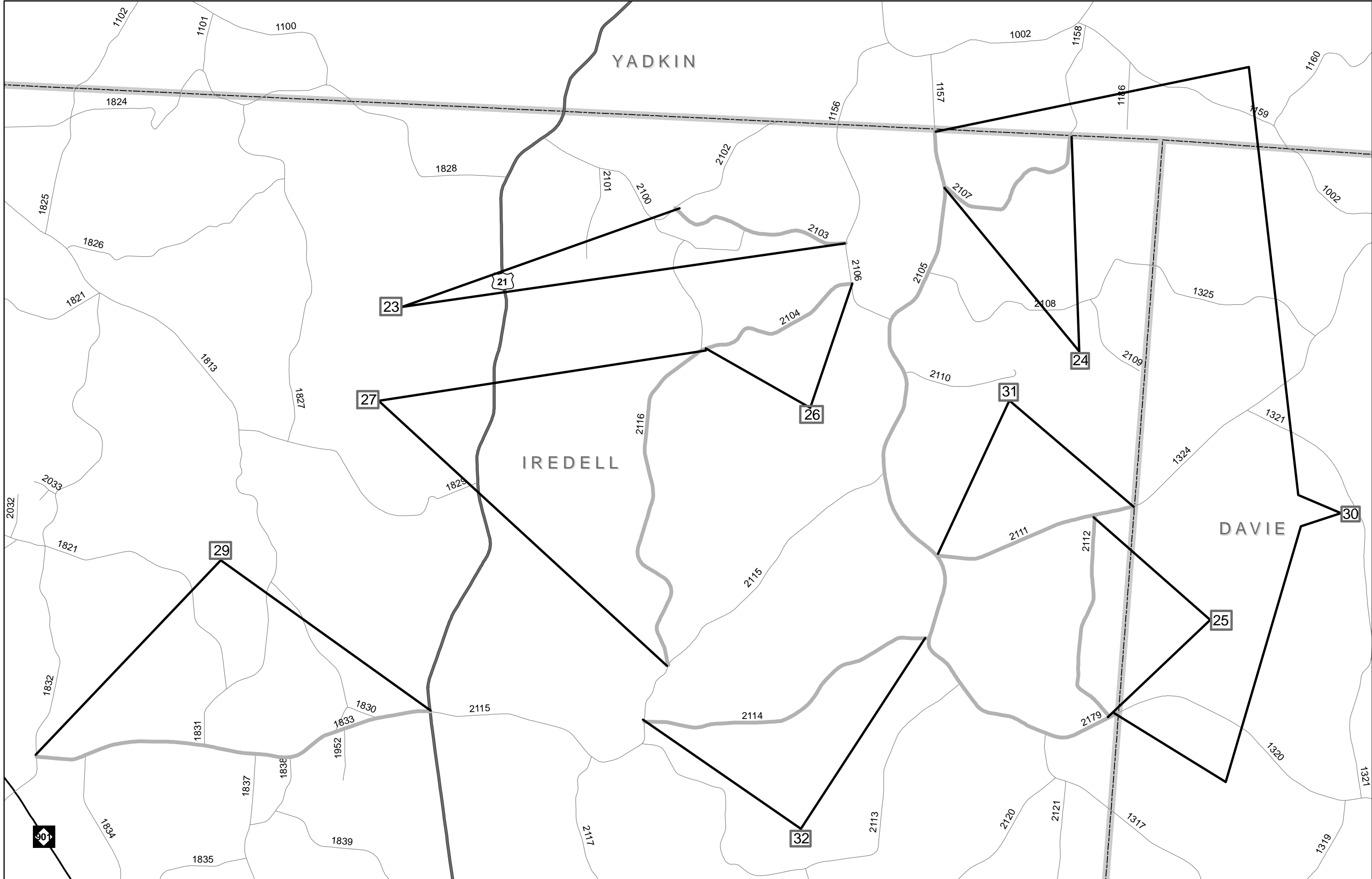

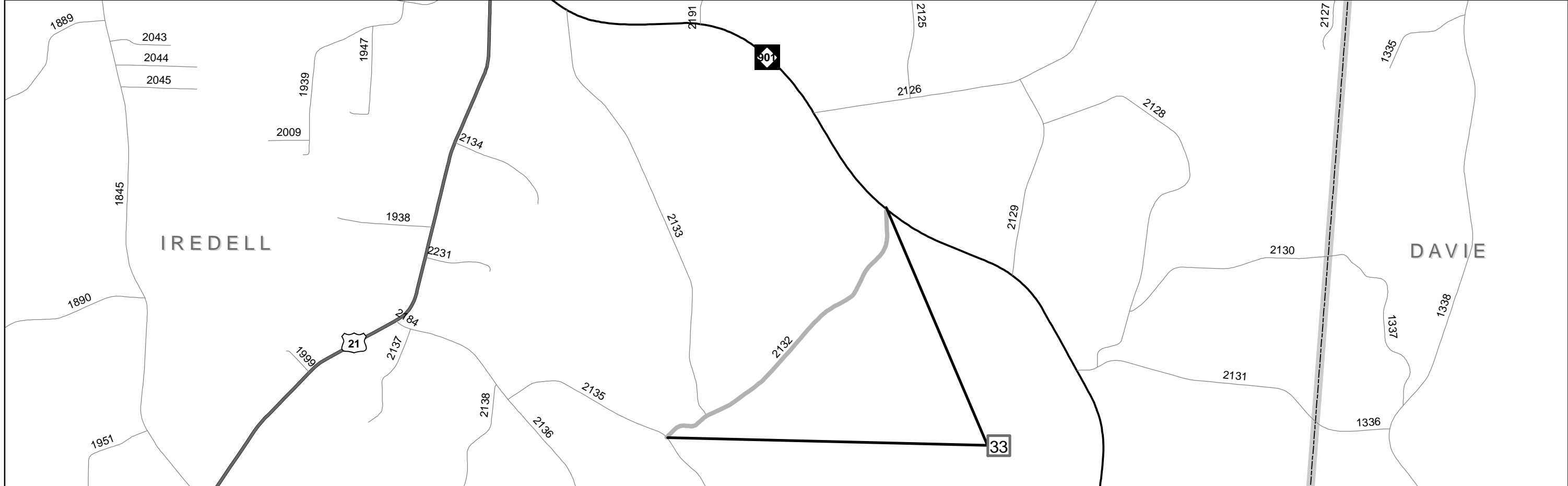
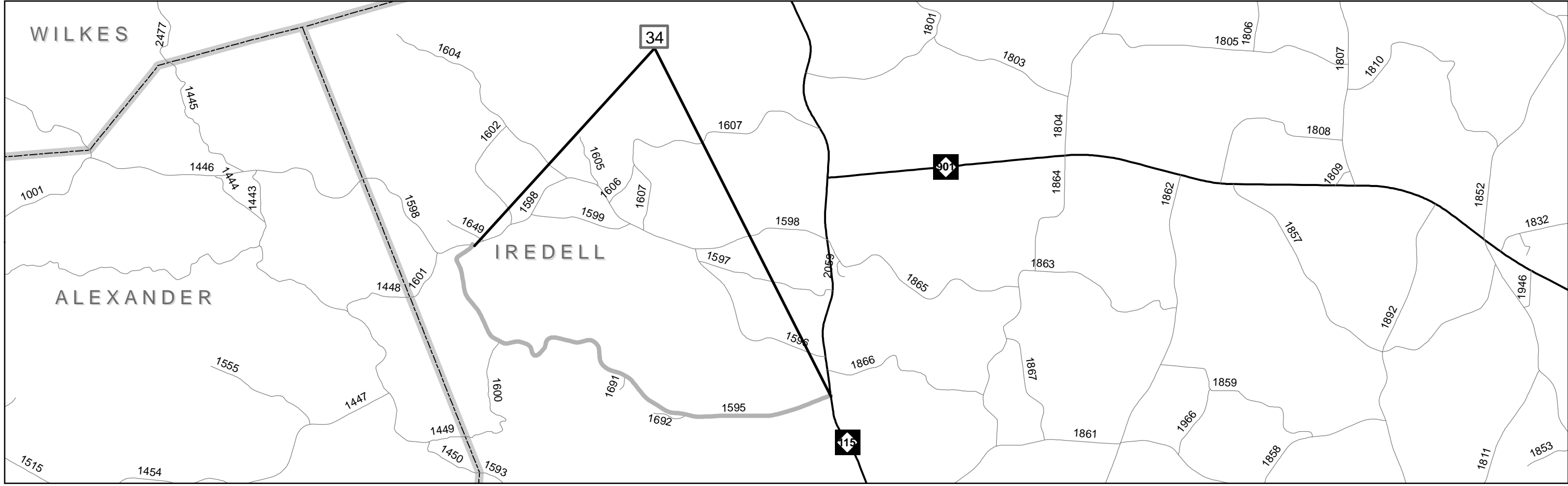

PAVEMENT SCHEDULE

STATE	PROJECT WBS	SHEET NUMBER
NC	2018CPT.12.18.20022	9
	2018CPT.12.18.20492	

F

ASPHALT SURFACE TREATMENT, DOUBLE SEAL, USING A TOP LIFT OF LIGHTWEIGHT AGGREGATE AND A BOTTOM LIFT OF 78M AGGREGATE.

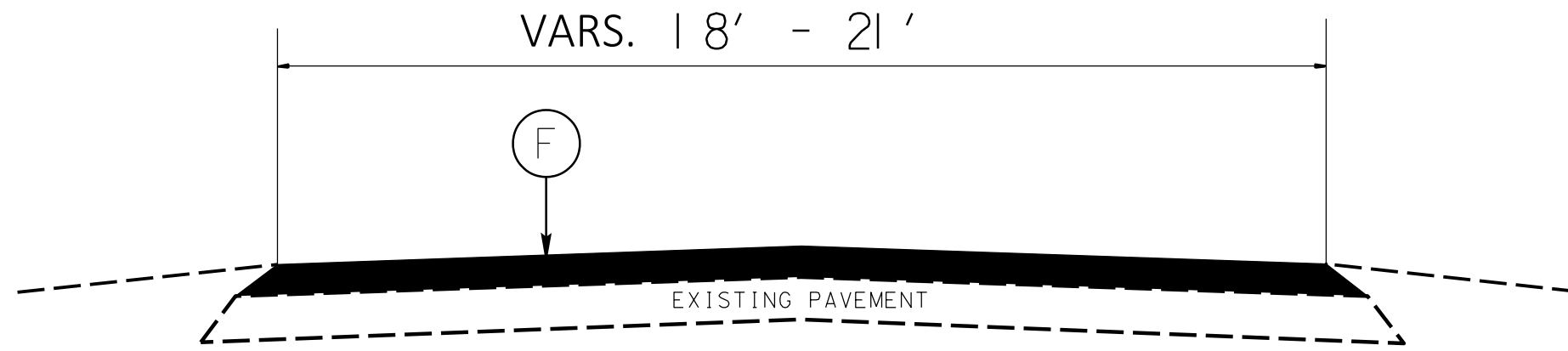

TYPICAL SECTION NO. 1

NOTES:

1. BRIDGES TO BE RESURFACED AT LOCATIONS AND TO DEPTH AS DIRECTED BY THE ENGINEER.
2. FOR BRIDGES WITH FLOOR DRAINS, CARE SHALL BE EXERCISED IN PLACING THE WEARING SURFACE AROUND FLOOR DRAINS SO AS NOT TO HINDER EFFECTIVE DRAINAGE. ALL DRAINS SHALL BE LEFT OPEN.

Typical Section
 Alexander & Iredell Co.
 2018-2019 Pvmt. Preservation

Checked by:

Drawn by: J. Barnett

PROJECT NO.	SHEET NO.	TOTAL NO.
2018CPT.12.18.20022	10	11
2018CPT.12.18.20492		

SUMMARY OF QUANTITIES

PROJECT NO	COUNTY	MAP NO	ROUTE	DESCRIPTION	TYP NO	LANES	LENGTH	WIDTH	180350000-E	183800000-E	214300000-E	445700000-N		
									ASPHALT SURFACE TREATMENT, DOUBLE SEAL	EMULSION FOR ASPHALT SURFACE TREATMENT	BLOTTING SAND	TEMPORARY TRAFFIC CONTROL		
									MI	FT	SY	GAL	TON	LS
2018CPT.12.18.20022	Alexander	1	SR 1453 (POPLAR SPRINGS RD.)	FROM SR 1456 (CHEATHAM FORD RD.) TO IREDELL CO. LINE	1	2	2.3	18.5	27,500	14,300	50.00			
2018CPT.12.18.20022	Alexander	2	SR 1473 (HUCKLEBERRY RIDGE RD.)	FROM SR 1456 (CHEATHAM FORD RD.) TO SR 1472 (LACKEY MTN. RD.)	1	2	3.06	18.5	36,500	18,980	50.00			
2018CPT.12.18.20022	Alexander	3	SR 1320 (NED HERMAN RD.)	FROM US 64 TO SR 1318 (ZEB WATTS RD.)	1	2	0.92	18	10,700	5,564	50.00			
2018CPT.12.18.20022	Alexander	4	SR 1318 (ZEB WATTS RD.)	FROM SR 1313 (THREE FORKS CHURCH RD.) TO SR 1307 (ALL HEALING SPRINGS RD.)	1	2	3.576	18.5	42,700	22,204	50.00			
2018CPT.12.18.20022	Alexander	5	SR 1329 (GLASS RD.)	FROM SR 1331 (LITTLE RIVER CHURCH RD.) TO SR 1328 (KIRBY LACKEY RD.)	1	2	1.02	21	13,850	7,202	50.00			
2018CPT.12.18.20022	Alexander	6	SR 1330 (QUAIL HOLLOW LANE)	FROM SR 1329 (GLASS RD.) TO DEAD END	1	2	0.66	20	8,500	4,420	50.00			
2018CPT.12.18.20022	Alexander	7	SR 1331/1332 (LITTLE RIVER CHURCH RD.)	FROM SR 1331 (LITTLE RIVER CHURCH RD.) TO SR 1333 (BEBBER RD.)	1	2	1.12	22	17,825	9,269	50.00			
2018CPT.12.18.20022	Alexander	8	SR 1317 (LINDSAY BEBBER RD.)	FROM SR 1313 (THREE FORKS CHURCH RD.) TO END OF PVMT.	1	2	0.8	19.5	10,100	5,252	50.00			
2018CPT.12.18.20022	Alexander	9	SR 1335 (RUSSELL GAP RD.)	FROM SR 1334 (MT. OLIVE CHURCH RD.) TO WILKES CO. LINE	1	2	2.15	21	29,250	15,210	50.00			
2018CPT.12.18.20022	Alexander	10	SR 1315 (CHAPMAN MILL RD.)	FROM SR 1307 (ALL HEALING SPRINGS RD.) TO SR 1313 (THREE FORKS CHURCH RD.)	1	2	2.08	18.5	24,800	12,896	50.00			
2018CPT.12.18.20022	Alexander	11	SR 1418 (CARSON CHAPEL RD.)	FROM SR 1412 (BLACK OAK RIDGE RD.) TO SR 1579 (COUNTRY RD.)	1	2	1.632	18	19,000	9,880	50.00			
2018CPT.12.18.20022	Alexander	12	SR 1422 (WHITE PLAINS RD.)	FROM NC 90 TO SR 1419 (ROCKY SPRINGS RD.)	1	2	1.865	21	25,275	13,143	50.00			
2018CPT.12.18.20022	Alexander	13	SR 1425 (ROCKY FACE CHURCH RD.)	FROM SR 1412 (BLACK OAK RIDGE RD.) TO SR 1419 (ROCKY SPRINGS RD.)	1	2	4.622	19	56,675	29,471	50.00			
2018CPT.12.18.20022	Alexander	14	SR 1466 (KING SPRINKLE RD.)	FROM SR 1461 (SHARPE MILL RD.) TO SR 1462 (CENTER CHURCH RD.)	1	2	1.197	19	14,700	7,644	50.00			
2018CPT.12.18.20022	Alexander	15	SR 1579 (COUNTRY RD.)	FROM SR 1419 (ROCKY SPRINGS RD.) TO END PVMT.	1	2	1.334	19	16,375	8,515	50.00			
TOTAL FOR PROJ NO. 2018CPT.12.18.20022									28.336	353,750	183,950	750.00	*	
2018CPT.12.18.20492	Iredell	16	SR 1527 (LINDEN LOOP)	FROM SR 1532 (BOLICK RD.) TO SR 1526 (NEW STERLING RD.)	1	2	0.949	18	11,025	5,733	50.00			
2018CPT.12.18.20492	Iredell	17	SR 1532 (BOLICK RD.)	FROM ALEXANDER CL TO SR 1527 (LINDEN LOOP)	1	2	1.899	20	24,525	12,753	50.00			
2018CPT.12.18.20492	Iredell	18	SR 1559 (LAURA JEANNE LN.)	FROM SR 1554 (MIDWAY RD.) TO SR 1560 (COVE GAP RD.)	1	2	0.27	19	3,325	1,729	50.00			
2018CPT.12.18.20492	Iredell	19	SR 1560 (COVE GAP RD.)	FROM SR 1554 (MIDWAY RD.) TO DEAD END	1	2	1.631	19	20,000	10,400	50.00			
2018CPT.12.18.20492	Iredell	20	SR 1561 (LIBERTY HILL RD./BOWLES FARM RD.)	FROM SR 1554 (MIDWAY RD.) TO NC 115	1	2	5.752	19	70,550	36,686	50.00			
2018CPT.12.18.20492	Iredell	21	SR 1565 (STIKELEATHER RD.)	FROM ALEXANDER COUNTY LINE TO SR 1554 (MIDWAY RD.)	1	2	1.252	19	15,375	7,995	50.00			
2018CPT.12.18.20492	Iredell	22	SR 1569 (ABNER RD.)	FROM SR 1554 (MIDWAY RD.) TO SR 1561 (LIBERTY HILL RD.)	1	2	1.816	19	22,275	11,583	50.00			
2018CPT.12.18.20492	Iredell	23	SR 2103 (MISTY RD.)	FROM SR 2102 (TOBACCO RD.) TO SR 2106 (RENEGAR RD.)	1	2	1.051	20	13,575	7,059	50.00			
2018CPT.12.18.20492	Iredell	24	SR 2107 (TOM LAUREN RD.)	FROM YADKIN COUNTY LINE TO SR 2105 (SANDY SPRINGS RD.)	1	2	1.027	20	13,275	6,903	50.00			
2018CPT.12.18.20492	Iredell	25	SR 2112 (JOYNER RD.)	FROM SR 2111 (DOBY RD.) TO SR 2179 (SANDY SPRINGS RD.)	1	2	1.234	20	15,950	8,294	50.00			
2018CPT.12.18.20492	Iredell	26	SR 2104 (NORTH MEADOW RD.)	FROM SR 2106 (RENEGAR RD.) TO SR 2116 (NORTH MEADOW RD.)	1	2	1	20	12,925	6,721	50.00			
2018CPT.12.18.20492	Iredell	27	SR 2116 (NORTH MEADOW RD.)	FROM SR 2104 (NORTH MEADOW RD.) TO SR 2115 (E. HOUSTONVILLE RD.)	1	2	2.055	20	26,550	13,806	50.00			
2018CPT.12.18.20492	Iredell	28	SR 1581 (DAMASCUS CHURCH RD.)	FROM SR 1585 (CATTLEMANS RD.) TO SR 1582 (OLD ARBOR LN)	1	2	1.786	19	21,900	11,388	50.00			
2018CPT.12.18.20492	Iredell	29	SR 1833 (W. HOUSTONVILLE RD.)	FROM US 21 TO SR 1832 (EAGLE MILLS RD.)	1	2	2.309	18.5	27,575	14,339	50.00			
2018CPT.12.18.20492	Iredell	30	SR 2105 (TURKEYFOOT RD.)/SR 2179 (SANDY SPRINGS RD.)	FROM YADKIN COUNTY LINE TO DAVIE COUNTY LINE	1	2	4.859	19	59,600	30,992	50.00			
2018CPT.12.18.20492	Iredell	31	SR 2111 (DOBY RD.)	FROM SR 2105 (SANDY SPRINGS RD.) TO DAVIE COUNTY LINE	1	2	1.148	18	13,350	6,942	50.00			
2018CPT.12.18.20492	Iredell	32	SR 2114 (REAVIS RD.)	FROM SR 2105 (SANDY SPRINGS RD.) TO SR 2115 (E. HOUSTONVILLE RD.)	1	2	1.789	20	23,100	12,012	50.00			
2018CPT.12.18.20492	Iredell	33	SR 2132 (KINDER RD.)	FROM NC 901 TO SR 2135 (SHAW RD.)	1	2	1.585	20	20,475	10,647	50.00			
2018CPT.12.18.20492	Iredell	34	SR 1595 (COOLBROOK RD.)	FROM NC 115 TO SR 1598 (LINNEYS MILL RD.)	1	2	3.87	19	47,475	24,687	50.00			
2018CPT.12.18.20492	Iredell	35	SR 1505 (GOBLE RD.)	FROM SR 1006 (ISLAND FOR RD.) TO SR 1503 (MOCK MILL RD.)	1	2	1.362	20	17,600	9,152	50.00			
2018CPT.12.18.20492	Iredell	36	SR 1615 (MT. HERMON RD.)	FROM SR 1510 (BEULAH RD.) TO SR 1005 (OLD MTN. RD.)	1	2	0.785	20	10,150	5,278	50.00			
2018CPT.12.18.20492	Iredell	37	SR 1512 (WOOD BRIDGE RD.)	FROM SR 1006 (ISLAND FORD RD.) TO NC 90	1	2	2.165	20	27,950	14,534	50.00			
TOTAL FOR PROJ NO. 2018CPT.12.18.20492									41.594	518,525	269,633	1,100.00	*	
GRAND TOTAL									69.93	872,275	453,583	1,850.00	1	

THERMOPLASTIC AND PAINT QUANTITIES

PROJECT NO	COUNTY	MAP NO	ROUTE	DESCRIPTION	TYP NO	LANES	LENGTH	WIDTH	441300000-E	471000000-E	472500000-E	481000000-E	481000000-E			
									WORK ZONE ADVANCE/GENERAL WARNING SIGNING	24" X 120 M WHITE THERMO	THERMO MSG SCHOOL 120 M	THERMO LT 90 M	4" WHITE PAINT	4" YELLOW PAINT		
									MI	FT	SF	LF	EA	EA	LF	LF
2018CPT.12.18.20022	Alexander	1	SR 1453 (POPLAR SPRINGS RD.)	FROM SR 1456 (CHEATHAM FORD RD.) TO IREDELL CO. LINE	1	2	2.3	18.5	260				48,750	48,750		
2018CPT.12.18.20022	Alexander	2	SR 1473 (HUCKLEBERRY RIDGE RD.)	FROM SR 1456 (CHEATHAM FORD RD.) TO SR 1472 (LACKEY MTN. RD.)	1	2	3.06	18.5	350				64,750	64,750		
2018CPT.12.18.20022	Alexander	3	SR 1320 (NED HERMAN RD.)	FROM US 64 TO SR 1318 (ZEB WATTS RD.)	1	2	0.92	18	105				19,500	19,500		
2018CPT.12.18.20022	Alexander	4	SR 1318 (ZEB WATTS RD.)	FROM SR 1313 (THREE FORKS CHURCH RD.) TO SR 1307 (ALL HEALING SPRINGS RD.)	1	2	3.576	18.5	405				75,550	75,550		
2018CPT.12.18.20022	Alexander	5	SR 1329 (GLASS RD.)	FROM SR 1331 (LITTLE RIVER CHURCH RD.) TO SR 1328 (KIRBY LACKEY RD.)	1	2	1.02	21	125				21,750	21,750		
2018CPT.12.18.20022	Alexander	6	SR 1330 (QUAIL HOLLOW LANE)	FROM SR 1329 (GLASS RD.) TO DEAD END	1	2	0.66	20	75				14,000	14,000		
2018CPT.12.18.20022	Alexander	7	SR 1331/1332 (LITTLE RIVER CHURCH RD.)	FROM SR 1331 (LITTLE RIVER CHURCH RD.) TO SR 1333 (BEBBER RD.)	1	2	1.12	22	135				26,100	26,100		
2018CPT.12.18.20022	Alexander	8	SR 1317 (LINDSAY BEBBER RD.)	FROM SR 1313 (THREE FORKS CHURCH RD.) TO END OF PVMT.	1	2	0.8	19.5	100				17,000	17,000		
2018CPT.12.18.20022	Alexander	9	SR 1335 (RUSSELL GAP RD.)	FROM SR 1334 (MT. OLIVE CHURCH RD.) TO WILKES CO. LINE	1	2	2.15	21	250				45,500	45,500		
2018CPT.12.18.20022	Alexander	10	SR 1315 (CHAPMAN MILL RD.)	FROM SR 1307 (ALL HEALING SPRINGS RD.) TO SR 1313 (THREE FORKS CHURCH RD.)	1	2	2.08	18.5	250				44,000	44,000		
2018CPT.12.18.20022	Alexander	11	SR 1418 (CARSON CHAPEL RD.)	FROM SR 1412 (BLACK OAK RIDGE RD.) TO SR 1579 (COUNTRY RD.)	1	2	1.632	18	200				34,750	34,750		
2018CPT.12.18.20022	Alexander	12	SR 1422 (WHITE PLAINS RD.)	FROM NC 90 TO SR 1419 (ROCKY SPRINGS RD.)	1	2	1.865	21	200	100	12	2	40,000	40,000		
2018CPT.12.18.20022	Alexander	13	SR 1425 (ROCKY FACE CHURCH RD.)	FROM SR 1412 (BLACK OAK RIDGE RD.) TO SR 1419 (ROCKY SPRINGS RD.)	1	2	4.622	19	525				97,750	97,750		
2018CPT.12.18.20022	Alexander	14	SR 1466 (KING SPRINKLE RD.)	FROM SR 1461 (SHARPE MILL RD.) TO SR 1462 (CENTER CHURCH RD.)	1	2	1.197	19	150				25,500	25,500		
2018CPT.12.18.20022	Alexander	15	SR 1579 (COUNTRY RD.)	FROM SR 1419 (ROCKY SPRINGS RD.) TO END PVMT.	1	2	1.334	19	150				28,250	28,250		
TOTAL FOR PROJ NO. 2018CPT.12.18.20022									28.336	3,280	100	12	2	603,150	603,150	
2018CPT.12.18.20492	Iredell	16	SR 1527 (LINDEN LOOP)	FROM SR 1532 (BOLICK RD.) TO SR 1526 (NEW STERLING RD.)	1	2	0.949	18	110				20,043	20,043		
2018CPT.12.18.20492	Iredell	17	SR 1532 (BOLICK RD.)	FROM ALEXANDER CL TO SR 1527 (LINDEN LOOP)	1	2	1.899	20	215				40,107	40,107		
2018CPT.12.18.20492	Iredell	18	SR 1559 (LAURA JEANNE LN.)	FROM SR 1554 (MIDWAY RD.) TO SR 1560 (COVE GAP RD.)	1	2	0.27	19	50				5,702	5,702		
2018CPT.12.18.20492	Iredell	19	SR 1560 (COVE GAP RD.)	FROM SR 1554 (MIDWAY RD.) TO DEAD END	1	2	1.631	19	200				34,447	34,447		
2018CPT.12.18.20492	Iredell	20	SR 1561 (LIBERTY HILL RD./BOWLES FARM RD.)	FROM SR 1554 (MIDWAY RD.) TO NC 115	1	2	5.752	19	650				121,482	121,482		
2018CPT.12.18.20492	Iredell	21	SR 1565 (STIKELEATHER RD.)	FROM ALEXANDER COUNTY LINE TO SR 1554 (MIDWAY RD.)	1	2	1.252	19	150				26,442	26,442		
2018CPT.12.18.20492	Iredell	22	SR 1569 (ABNER RD.)	FROM SR 1554 (MIDWAY RD.) TO SR 1561 (LIBERTY HILL RD.)	1	2	1.816	19	215				38,354	38,354		
2018CPT.12.18.20492	Iredell	23	SR 2103 (MISTY RD.)	FROM SR 2102 (TOBACCO RD.) TO SR 2106 (RENEGAR RD.)	1	2	1.051	20	125				22,197	22,197		
2018CPT.12.18.20492	Iredell	24	SR 2107 (TOM LAUREN RD.)	FROM YADKIN COUNTY LINE TO SR 2105 (SANDY SPRINGS RD.)	1	2	1.027	20	125				21,690	21,690		
2018CPT.12.18.20492	Iredell	25	SR 2112 (JOYNER RD.)	FROM SR 2111 (DOBY RD.) TO SR 2179 (SANDY SPRINGS RD.)	1	2	1.234	20	150				26,062	26,062		
2018CPT.12.18.20492	Iredell	26	SR 2104 (NORTH MEADOW RD.)	FROM SR 2106 (RENEGAR RD.) TO SR 2116 (NORTH MEADOW RD.)	1	2	1	20	115				21,120	21,120		

SIGNING FOR ASPHALT SURFACE TREATMENT

LEGEND

- ▷ PORTABLE SIGN
- └ STATIONARY SIGN
- ← DIRECTION OF TRAFFIC FLOW

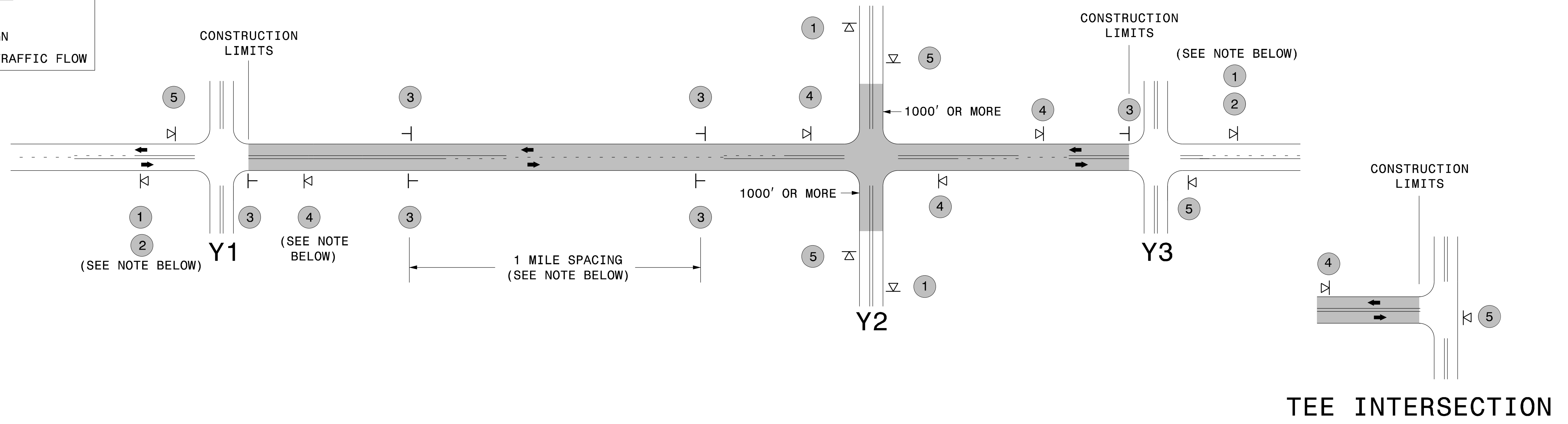

MAINLINE (-L-) SIGNING

-Y- LINE SIGNING

SIGNING NOTES AND PLACEMENT PER DIRECTION	<p>1</p> <p>W20-1 48" X 48"</p> <p>2</p> <p>W7-3qP 24" X 18"</p>	<p>- PLACE 1000' PRIOR TO BEGINNING OF CONSTRUCTION LIMITS. ONLY USED ON -Y- LINES IF RESURFACING LIMITS EXTEND 1000' ALONG -Y- LINE.</p> <p>- SIGN #2 ONLY USED WHEN RESURFACING LIMITS ARE 2 OR MORE MILES IN LENGTH. ROUND UP TO THE NEAREST WHOLE NUMBER. DO NOT USE FRACTIONAL OR DECIMAL NUMBERS.</p>	<p>STATIONARY SIGNING NOT REQUIRED FOR THE FOLLOWING -Y- LINE CONDITIONS:</p> <ol style="list-style-type: none"> 1) LESS THAN 1000' OF RESURFACING ALONG -Y- LINE 2) SUBDIVISION ROADS 3) DEAD END ROADS <p>WHEN PAVING/CONSTRUCTION ACTIVITIES PROCEED ACROSS AN UNSIGNED -Y- LINE, PORTABLE ADVANCE WARNING SIGNS SHALL BE USED ALONG THE -Y- LINE AS SHOWN BELOW. REMOVE UPON COMPLETION OF WORK.</p> <div style="display: flex; justify-content: space-around;"> <div> <p>W20-1 48" X 48"</p> <p>PLACED 500' IN ADVANCE OF FLAGGER.</p> </div> <div> <p>W20-7 A 48" X 48"</p> <p>PLACED 250' IN ADVANCE OF FLAGGER.</p> </div> </div>
	<p>3</p> <p>W8-7 48" X 48"</p> <p>SP 48" X 48"</p>	<p>- ALTERNATE THE FOLLOWING TWO SIGNS:</p> <p>- STARTING WITH "LOOSE GRAVEL" (W8-7) FOLLOWED BY "UNMARKED PAVEMENT".</p> <p>- PLACE INITIALLY AT THE CONSTRUCTION LIMITS AND SPACED 1 MILE APART THEREAFTER.</p> <p>- AT TEE INTERSECTIONS INSTALL INITIALLY 0.5 MILE FROM INTERSECTION AND SPACE 1 MILE APART THEREAFTER.</p>	
	<p>4</p> <p>SP 13106 48" X 48"</p>	<p>- THESE ARE FOR -Y- LINES THAT ARE "THROUGH" ROADWAYS. DEAD END AND SUBDIVISION ROADS ARE NOT "THROUGH" ROADWAYS.</p> <p>- INSTALL 500' +/- FROM EACH -Y- LINE APPROACH AS SHOWN ABOVE.</p> <p>- FOR MULTIPLE -Y- LINES THAT ARE SEPARATED BY 0.25 MILES OR LESS, TREAT AS A SINGLE UNIT AND INSTALL WITHIN 500' OF EACH APPROACH.</p> <p>- A MAXIMUM OF 2 SIGN SETS PER MILE. DO NOT INSTALL WHEN -Y- LINES ARE WITHIN 0.5 MILES FROM "END ROAD WORK" SIGN.</p>	
	<p>5</p> <p>G20-2 A 48" X 24"</p>	<p>PLACE 500' FOLLOWING THE END OF CONSTRUCTION LIMITS OR AS SHOWN WHEN WORK ENDS AT A 3-WAY TEE INTERSECTION.</p>	
	<p>THE ABOVE SIGNS ARE ALL THAT ARE REQUIRED FOR A CONTRACTOR TO BEGIN A RESURFACING CONTRACT. ANY ADDITIONAL SIGNS REQUESTED BY NCDOT DIVISIONS SHALL BE INSTALLED WITHIN 7 BUSINESS DAYS OF THE START OF CONTRACT WORK.</p>		

MAPS LESS THAN 2 MILES

FOR AST RESURFACING MAPS WITH CONSTRUCTION LIMITS LESS THAN 2 MILES IN LENGTH, USE A STATIONARY "LOOSE GRAVEL" SIGN AT THE BEGINNING CONSTRUCTION LIMIT FOLLOWED BY AN "UNMARKED PAVEMENT" SIGN MIDWAY THROUGH AND AN "END ROAD WORK" SIGN AT THE END CONSTRUCTION LIMIT.

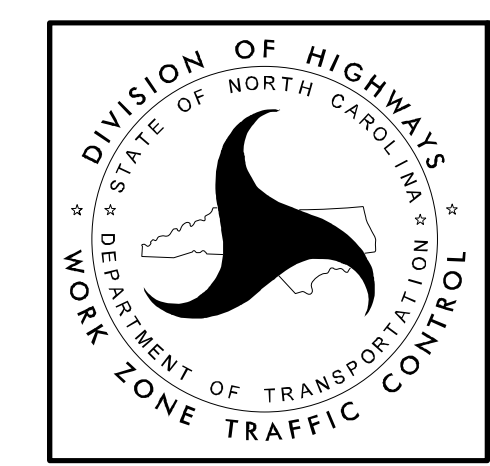

ADVANCE WARNING SIGNS FOR 2-LANE ROADWAY ASPHALT SURFACE TREATMENT